



Sitting Pretty.

The Waverly Community House is a living work of art, a place for residents to experience the beauty and tranquility of our community. The Comm’s original design has accommodated many changes, including community recreation renovations. But its original purpose endures: people continue to visit the Comm to enjoy its peacefulness, and those who participate in more active recreation and cultural activities come here to do so in an historic, cherished setting.

Adopting a bench is a lovely and unique way to establish a serene memory for someone special. Or to mark a special event. Constructed from ecologically grown and harvested teak timbers, the benches are sturdy enough to withstand constant use. Benches feature an 18-inch deep seat and 2 ¼-inch leg timbers. All bench adoptions will receive maintenance consistent with Comm standards.

If you are interested in adopting a bench call today...570.586.8191, extension 3.



Waverly Community House
Adopt-A-Bench Program

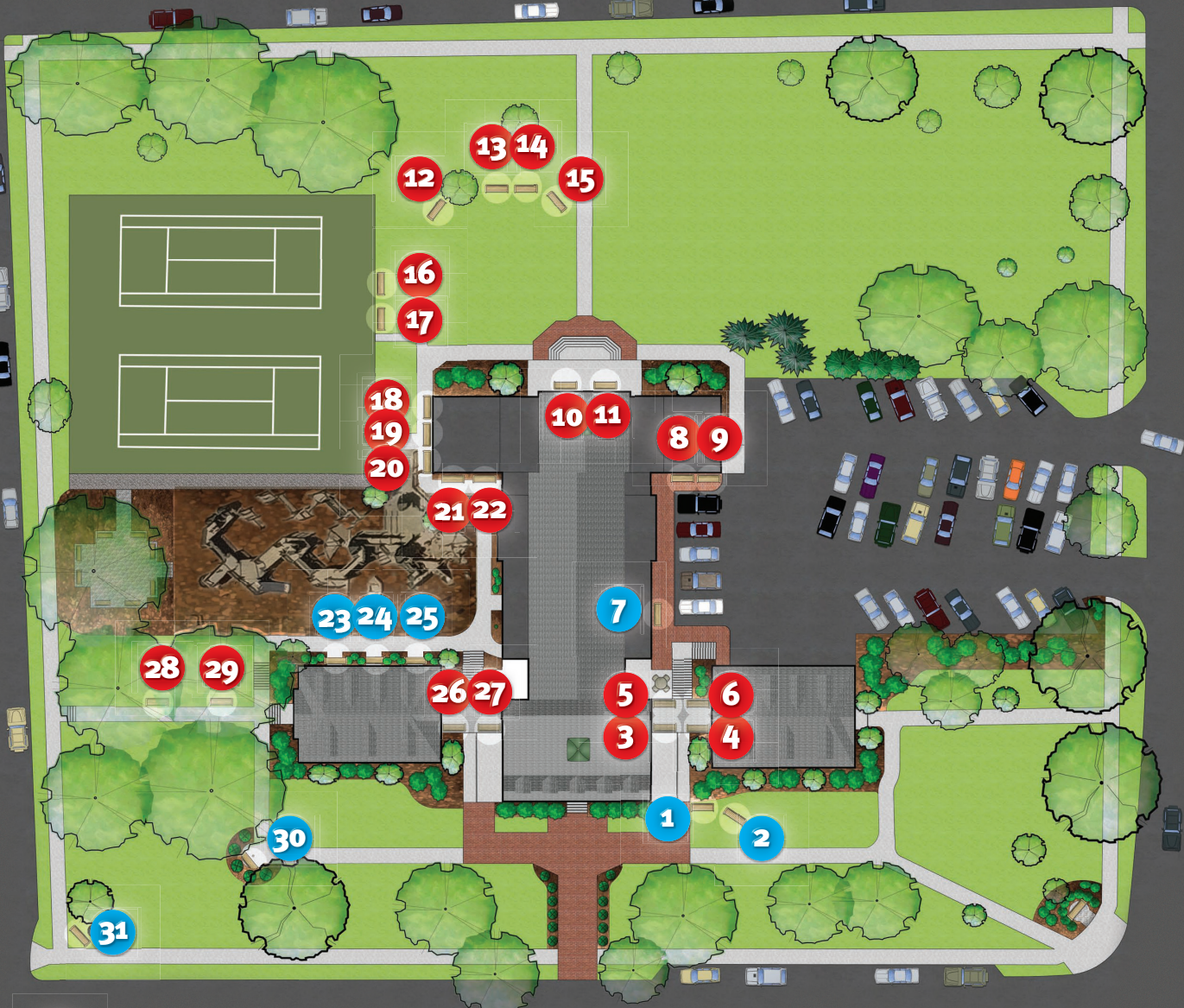

Available

Taken

Select your family or group’s bench location from the overhead map above; all choices are first-come basis

Waverly Community House
Adopt-A-Bench Program

I /we will gladly support the Waverly Community House Adopt-A-Bench Program and request the following number locations (subject to first-come basis):

Choice #1 Choice #2 Choice #3 We will call to confirm
Choose up to four lines of text, 42 characters per line including spaces. One line may have larger letters (maximum 20 characters including spaces). Please indicate which line is to be Large VS Small characters by circling L or S in first box below:

</



The Waverly Community House is proud to offer the community the opportunity to honor a person, group or event important to your life through our **Adopt-A-Bench Program**. This popular naming opportunity allows you to have a sturdy, beautiful teak wood bench grace the Comm's sidewalks and garden areas complete with a **2" X 8" brass plaque** engraved with a personalized inscription.

When you choose to participate in the Adopt-A-Bench program, your philanthropic contribution makes you a partner in our ongoing work to sustain

- The John H. Richardson Family
- Waverly's premier gathering place for people of all ages and walks of life. The Comm has been serving our community since 1920 – the heart and soul of social, recreational and cultural activities for individuals and their families.

Through **your donation of \$2500**, Comm staff will install and maintain a beautiful custom built bench at a location that meets your desires and the needs of open space visitors. The unique properties of teak combined with superior craftsmanship ensure your donation will remain a source of enjoyment for decades.



1115 N. Abington Rd.
Waverly, PA 18471

BECOME A BENCHMARK
FOR OUR COMMUNITY.



Adopt-A-Bench Program



To Honor...To Remember
An Individual, Family or Group